

COPYRIGHT © Hangzhou EZVIZ Software Co., Ltd. ALL RIGHTS RESERVED.

Any and all information, including, among others, wordings, pictures, graphs are the properties of Hangzhou EZVIZ Software Co., Ltd. (hereinafter referred to as “EZVIZ”). This user manual (hereinafter referred to as “the Manual”) cannot be reproduced, changed, translated, or distributed, partially or wholly, by any means, without the prior written permission of EZVIZ. Unless otherwise stipulated, EZVIZ does not make any warranties, guarantees or representations, express or implied, regarding to the Manual.

About this Manual

The Manual includes instructions for using and managing the product. Pictures, charts, images and all other information hereinafter are for description and explanation only. The information contained in the Manual is subject to change, without notice, due to firmware updates or other reasons. Please find the latest version in the EZVIZ™ website (<http://www.ezviz.com>).

Revision Record

New release – September, 2025

Trademarks Acknowledgement

EZVIZ™, ™, and other EZVIZ's trademarks and logos are the properties of EZVIZ in various jurisdictions. Other trademarks and logos mentioned below are the properties of their respective owners.

Legal Disclaimer

TO THE MAXIMUM EXTENT PERMITTED BY APPLICABLE LAW, THE PRODUCT DESCRIBED, WITH ITS HARDWARE, SOFTWARE AND FIRMWARE, IS PROVIDED “AS IS”, WITH ALL FAULTS AND ERRORS, AND EZVIZ MAKES NO WARRANTIES, EXPRESS OR IMPLIED, INCLUDING WITHOUT LIMITATION, MERCHANTABILITY, SATISFACTORY QUALITY, FITNESS FOR A PARTICULAR PURPOSE, AND NON-INFRINGEMENT OF THIRD PARTY. IN NO EVENT WILL EZVIZ, ITS DIRECTORS, OFFICERS, EMPLOYEES, OR AGENTS BE LIABLE TO YOU FOR ANY SPECIAL, CONSEQUENTIAL, INCIDENTAL, OR INDIRECT DAMAGES, INCLUDING, AMONG OTHERS, DAMAGES FOR LOSS OF BUSINESS PROFITS, BUSINESS INTERRUPTION, OR LOSS OF DATA OR DOCUMENTATION, IN CONNECTION WITH THE USE OF THIS PRODUCT, EVEN IF EZVIZ HAS BEEN ADVISED OF THE POSSIBILITY OF SUCH DAMAGES.

TO THE MAXIMUM EXTENT PERMITTED BY APPLICABLE LAW, IN NO EVENT SHALL EZVIZ'S TOTAL LIABILITY FOR ALL DAMAGES EXCEED THE ORIGINAL PURCHASE PRICE OF THE PRODUCT.

EZVIZ DOES NOT UNDERTAKE ANY LIABILITY FOR PERSONAL INJURY OR PROPERTY DAMAGE AS THE RESULT OF PRODUCT INTERRUPTION OR SERVICE TERMINATION CAUSED BY: A) IMPROPER INSTALLATION OR USAGE OTHER THAN AS REQUESTED; B) THE PROTECTION OF NATIONAL OR PUBLIC INTERESTS; C) FORCE MAJEURE; D) YOURSELF OR THE THIRD PARTY, INCLUDING WITHOUT LIMITATION, USING ANY THIRD PARTY'S PRODUCTS, SOFTWARE, APPLICATIONS, AND AMONG OTHERS.

REGARDING TO THE PRODUCT WITH INTERNET ACCESS, THE USE OF PRODUCT SHALL BE WHOLLY AT YOUR OWN RISKS. EZVIZ SHALL NOT TAKE ANY RESPONSIBILITIES FOR ABNORMAL OPERATION, PRIVACY LEAKAGE OR OTHER DAMAGES RESULTING FROM CYBER ATTACK, HACKER ATTACK, VIRUS INSPECTION, OR OTHER INTERNET SECURITY RISKS; HOWEVER, EZVIZ WILL PROVIDE TIMELY TECHNICAL SUPPORT IF REQUIRED. SURVEILLANCE LAWS AND DATA PROTECTION LAWS VARY BY JURISDICTION. PLEASE CHECK ALL RELEVANT LAWS IN YOUR JURISDICTION BEFORE USING THIS PRODUCT IN ORDER TO ENSURE THAT YOUR USE CONFORMS TO THE APPLICABLE LAW. EZVIZ SHALL NOT BE LIABLE IN THE EVENT THAT THIS PRODUCT IS USED WITH ILLEGITIMATE PURPOSES.

IN THE EVENT OF ANY CONFLICTS BETWEEN THE ABOVE AND THE APPLICABLE LAW, THE LATTER PREVAILS.

Table of Contents

Overview	1
1. Package Contents	1
2. Basics	1
Get the EZVIZ App.....	2
Preparation.....	2
1. Detach the Bottom Cover.....	2
2. Remove the Insulation Strip.....	2
Add the Device.....	3
Installation	4
About the Battery	5
1. Battery Replacement	5
2. Lithium Ion Battery (CR1632)	6
Information for Private Households	7

Overview

1. Package Contents



Open/Close Sensor (×1)



Double-sided Tape (×3)



Regulatory Information (×1)



Quick Start Guide (×1)

2. Basics

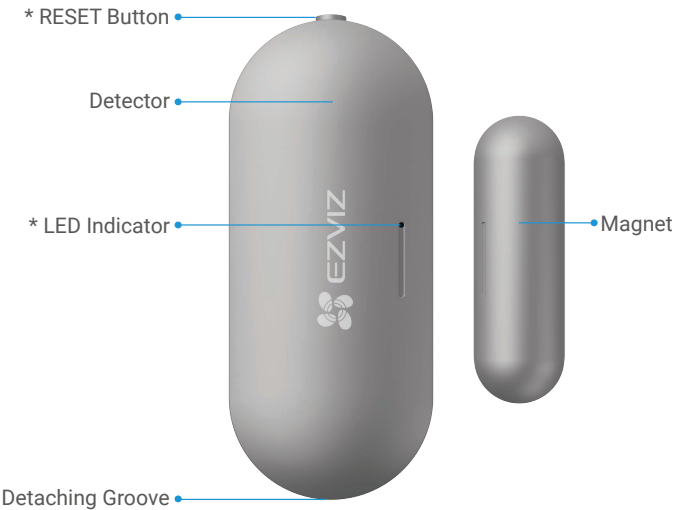

Name	Description
RESET Button	Press and hold the button for 5 seconds. The device will enter adding mode.
LED Indicator	<ul style="list-style-type: none">Continuously fast-flashing blue: The device is in adding mode (effective duration: 180 seconds).Flashing blue once: Door opening/closing signals triggered.

Get the EZVIZ App

1. Connect your mobile phone to Wi-Fi (suggested).
2. Download and install the EZVIZ App by searching "EZVIZ" in the App Store or Google Play™.
3. Launch the app and register an EZVIZ user account.

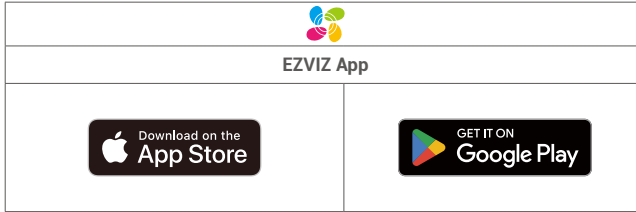

i If you have already used the app, please make sure that it is the latest version. To find out if an update is available, go to the app store and search for EZVIZ.

Preparation

1. Detach the Bottom Cover

Detach the bottom cover from the sensor at the detaching groove.

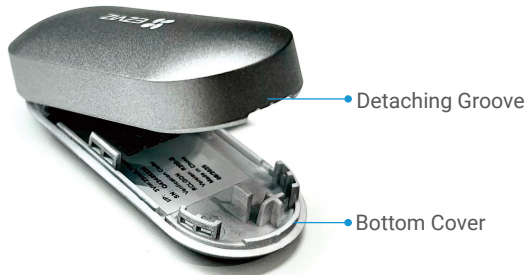

2. Remove the Insulation Strip

Remove the battery insulation strip as instructed in the figure below.

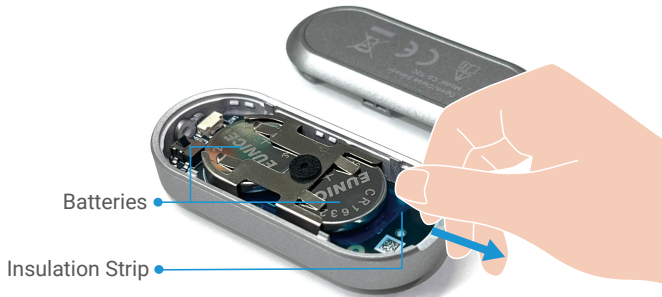

- Keep your hands dry and clean when touching the circuit board.
- When the battery level is low, a low battery notification will be pushed to the EZVIZ App to remind you to replace batteries. For how to replace the batteries, please refer to ["Battery Replacement"](#).

Add the Device

Add the open/close sensor to other devices according to the following steps. Here takes EZVIZ Door Lock as an example.

- Place the open/close sensor as close to the door lock as possible when adding it.
- Make sure that the door lock has been installed properly and added to the EZVIZ App.

1. Log in to your EZVIZ App account.
2. Tap the **door lock** device card on the "Devices" page.
3. On the device page of the door lock, select "Settings > Accessory Management > Bluetooth Door Sensor" to go to the Scan QR Code page.
4. Press and hold the RESET button of the open/close sensor for 5 seconds until the LED indicator turns fast-flashing blue. The sensor enters adding mode.

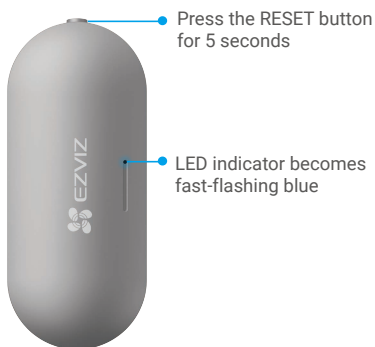

- The effective duration of the adding mode is 180 seconds. Please complete adding within 180 seconds. If the adding mode times out, press and hold the RESET button for 5 seconds again.
- If you're adding the sensor to DL01 door lock, once the sensor enters the adding mode, it will be automatically paired with the door lock and does not require QR code scanning. You can proceed directly to step 6.

5. Scan the QR code on the bottom cover of the sensor or on the cover of the quick start guide.

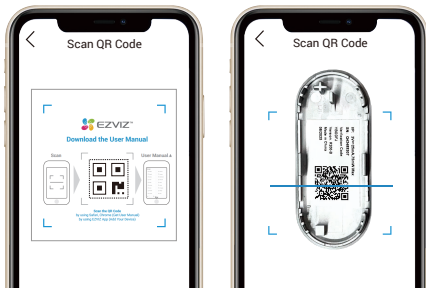

6. Follow the EZVIZ App wizard to finish adding and add the device to the door lock.
7. Install the bottom cover back to the sensor.

Installation

- The sensor must be installed away from magnetic field, and when doors or windows are closed, the distance between the sensor and the magnet should be less than 20 mm.
- Before sticking the sensor, clean the dust on the surface of the door or window first. Do not stick the sensor on lime-washed walls.
- The installation height should not exceed 1.8 meters.
- The working temperature range of the sensor is $-10^{\circ}\text{C}\sim 55^{\circ}\text{C}$.

1. Select a place where the sensor can be installed.
2. Stick one of the bigger double-sided tapes (included in the package) onto the bottom cover of the sensor.

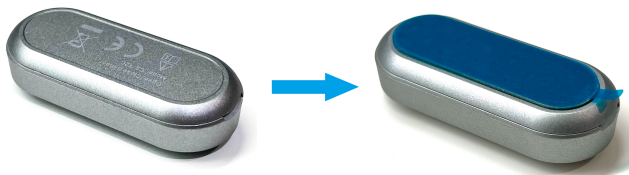

3. Remove the protective film of the double-sided tape both on the sensor and the magnet.
4. Stick the sensor and the magnet at your desired installation location, ensuring that the alignment slots on the sensor and the magnet are horizontally aligned.

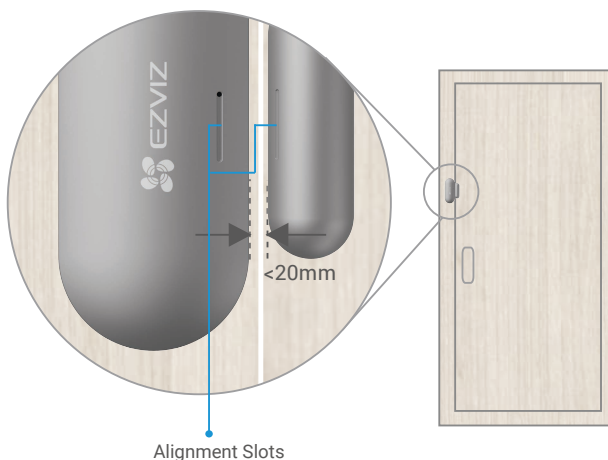

5. Press the sensor against the installation surface with force for about 20 seconds to ensure that it is securely fixed.
- After installation, we recommend closing the door and verifying whether a "Door closed" notification appears in the EZVIZ App. If the notification appears even though the door is not fully closed, it may be due to the sensor being too close to the magnet. In this case, please increase the distance between them.

About the Battery

1. Battery Replacement

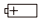
- ⚠ • Use CR1632 batteries for replacement. Risk of explosion exists if the battery is replaced by an incorrect type.
- Improper replacement of the battery with an incorrect type may defeat a safeguard (for example, in the case of some lithium battery types).
- Do not dispose of the battery into fire or a hot oven, or mechanically crush or cut the battery, which may result in an explosion.
- Do not leave the battery in an extremely high temperature surrounding environment or extremely low air pressure, which may result in an explosion or the leakage of flammable liquid or gas.
- Dispose of used batteries according to the instructions.
-  identifies the battery holder itself and identifies the positioning of the cell(s) inside the battery holder.
- "+" identifies the positive terminal(s) of device which is used with, or generates direct current, "-" identifies the negative terminal(s) of device which is used with, or generates direct current.

- 1 Detach the bottom cover from the sensor at the detaching groove.



- 2 Remove the batteries from the sensor by pushing the batteries out in the direction as shown below.

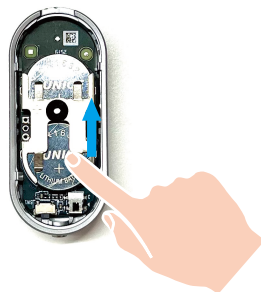

- 3 Insert new batteries into the slots, with the positive side facing up.



- 4 Install the bottom cover back onto the sensor.



After replacement, test the device for correct operation. If the device is not working properly, please add the device to the EZVIZ App again or contact our technical support.

2. Lithium Ion Battery (CR1632)

Hazardous Ingredients (Chemical Name)	CAS No.	EC NO.	Concentration (wt%)
Manganese dioxide (MnO ₂)	1313-13-9	215-202-6	31.7
Graphite (C)	7782-42-5	231-955-3	3.1
Poly (tetrafluoroethylene) (PTFE)	9002-84-0	206-370-1	0.3
Polypropylene (pp)	9003-07-0	--	5.5
Stainless steel	12597-68-1	--	46.5
Lithium	7439-93-2	231-102-5	1.8
Propylene carbonate (PC)	108-32-7	203-572-1	4.7
Dimethoxy ethane (DME)	110-71-4	203-794-9	4.2
Lithium Perchlorate (LiClO ₄)	7791-03-9	232-237-2	2.2

Information for Private Households

1. Separate collection of waste equipment: Electrical and electronic equipment that has become waste is referred to as waste equipment. Owners of waste equipment must dispose of it separately from unsorted municipal waste. In particular, waste equipment does not belong in household waste, but in special collection and return systems.
2. Batteries and rechargeable batteries as well as lamps: Owners of waste equipment shall, as a rule, separate waste batteries and rechargeable batteries that are not enclosed in the waste equipment, which can be removed from the waste equipment without being destroyed, from the waste equipment before handing them in at a collection point. This does not apply if waste equipment is prepared for reuse with the participation of a public waste management authority.
3. Options for returning waste equipment: Owners of waste equipment from private households can return it free of charge to the collection points of the public waste management authorities or to the take-back points set up by manufacturers or distributors within the meaning of the Electrical and Electronics Equipment Law. Stores with a sales area of at least 400 m² for electrical and electronic equipment and those grocery stores with a total sales area of at least 800 m² that offer electrical and electronic equipment several times a year or on a permanent basis and make it available in the market are required to take it back. This also applies in the case of distribution using means of distance communication, if the storage and shipping areas for electrical and electronic equipment are at least 400 m² or the total storage and shipping areas are at least 800 m². Distributors shall, in principle, ensure take-back by providing suitable return facilities at a reasonable distance from the respective end user. The possibility of returning waste equipment free of charge exists for distributors who are obliged to take it back, among other things, if a new similar device that essentially fulfills the same functions is delivered to an end user.
4. Privacy Notice: Waste equipment often contains sensitive personal data. This applies in particular to devices of information and telecommunications technology such as computers and smartphones. In your own interest, please note that each end user is responsible for deleting the data on the waste equipment to be disposed of.
5. Meaning of the symbol "crossed-out wheelie bin": The symbol of a crossed-out wheelie bin regularly depicted on electrical and electronic equipment indicates that the respective device is to be collected separately from unsorted municipal waste at the end of its service life.